

HVE Mirror Connect Kit

High Volume Evacuation

REF HVEMCKIT

INSTRUCTIONS FOR USE

HVE Mirror Connect Kit Instructions for use:

1. Using embossed guidelines on the HVE, slide Mirror Head into HVE Mirror Connect fully until Mirror Head locks into place to match orientation.
2. Attach HVE Mirror Connect hose to your practice's device.
3. Insert assembled HVE Mirror Connect to HVE Mirror Connect hose.
4. Use HVE Mirror Connect on patient during procedure.
5. After procedure is completed, remove Mirror Head from HVE Mirror Connect.
6. Dispose of HVE Mirror Connect.

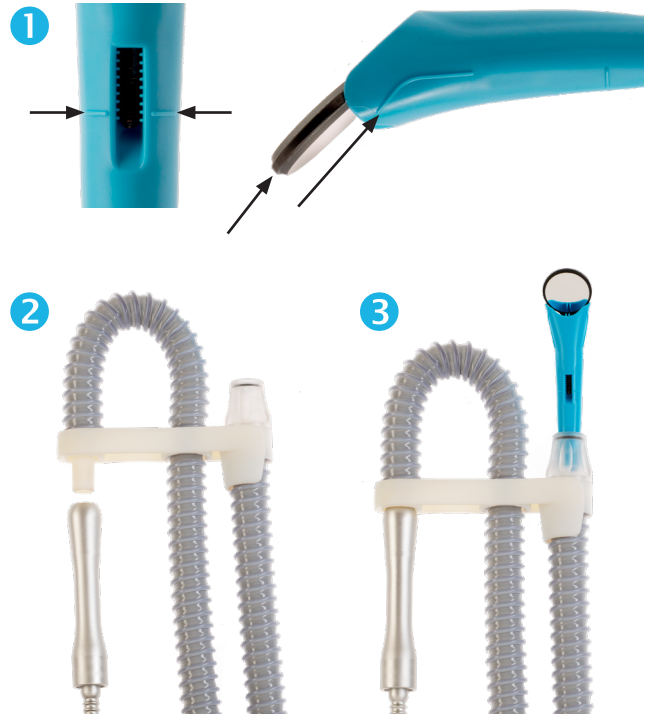

Note: The HVE Mirror Connect includes embossed guidelines on the HVE to aid Mirror Head insertion. Two curved guidelines on the HVE sides designate the orientation of the Mirror Head, and one straight guideline on the shaft indicates the appropriate depth of Mirror Head insertion.

Warning: HVE Mirror Connect is a single-use product and is not intended to be autoclaved.

Warning: Autoclave the Mirror Head component separately after every use. Refer to the instructions for use provided for mirror head(s), such as the HuFriedyGroup Instrument Reprocessing Guide for HuFriedyGroup Mirror Heads.

Warning: Do not sterilize HVE Hose. Wipe with a EPA-approved surface disinfectant.

Hu-Friedy



Hu-Friedy Mfg. Co., LLC
3232 N. Rockwell Street | Chicago, IL 60618 | USA
1-800-Hu-Friedy | info@hu-friedy.com

HFL-900 / REV 2 - 01/2025

All company and product names are trademarks of Hu-Friedy Mfg. Co., LLC, its affiliates or related companies, unless otherwise noted.
©2025 Hu-Friedy Mfg. Co., LLC. All rights reserved.

