

# Maintaining Your PWR Piezo

## Daily Care Tips for Your Device



Ensure staying power and protect your investment by regularly maintaining your PWR Piezo Scaling device. Adhere to the following PWRful tips for **Best In Practice** performance.



### After Each Patient Maintenance Checklist

- ☐ Use Flush function with your PWR Piezo LED Handpiece attached using distilled water.
- ☐ Remove PWR Piezo Tip from PWR Piezo LED Handpiece using the Torque Wrench.
- ☐ Disconnect PWR Piezo LED Handpiece from cord.

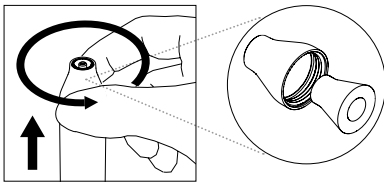

- ☐ Clean and Sterilize PWR Air Polishing and Piezo Handpieces, Torque Wrench and PWR Piezo Tip(s) used, all in individual sterilization pouches.

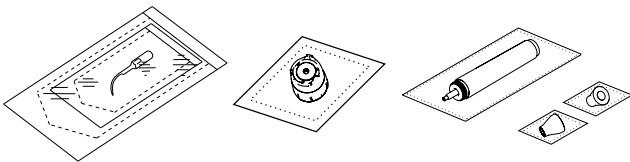

- ☐ Clean non-sterilizable parts of the device with a compatible EPA-registered intermediate-level surface disinfectant.

### End of Day Maintenance Checklist

- ☐ Use the Flush function with your PWR Piezo LED Handpiece attached using distilled water.
- ☐ Detach 500ml bottle and use the Flush function again to remove all remaining water.
- ☐ Ensure that your PWR Pair device is switched off.
- ☐ Clean the PWR Piezo device, handpiece cord and footswitch using a clean, dry cloth with a low fiber release, dampened with a detergent solution (pH 6-9).

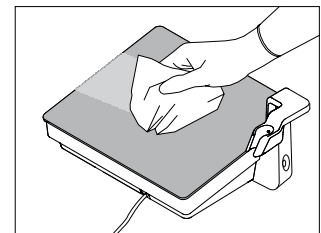
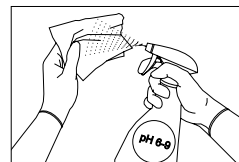

For a full list of instructions, please refer to the **PWR Piezo Instructions For Use**.